



बैंक ऑफ़ बड़ोदा  
Bank of Baroda



**BANK OF BARODA  
REGIONAL OFFICE, CUTTACK**

**TENDER DOCUMENT  
FOR  
INTERIOR FURNISHING WORKS OF **BANKI BRANCH**  
(FURNISHING WORKS)**

NAME OF THE TENDERER: .....

ADDRESS OF THE TENDERER: .....

DATE OF TENDER PUBLISH: From **25.04.2024 to 15.05.2024**

DATE OF SUBMISSION OF TENDER: **15/05/2024 upto 3.00 PM**

DATE OF OPENING OF TENDER: **15/05/2024 at 3.30 PM**

PLACE OF SUBMISSION OF TENDER:  
THE REGIONAL MANAGER  
**BANK OF BARODA,**  
REGIONAL OFFICE,  
CUTTACK.

**CONSULTANT**

**M/s. CURVES ARCHITECTURE  
Plot no- 33, Bankers Enclave,  
Palasuni, Bhubaneswar  
Mobile - 9438562471**

## TENDER NOTICE

**Sealed Tenders are invited from the Contractors having current IT clearance, Valid GSTIN. having experience of similar nature works, and not involve any Civil Suits / Litigations aroused during execution of the contracts in the last 5 years for the following works:-**

- 1) Name of the work : Interior Furnishing work of BANKI Branch.
  - 2) Location of the work : BANKI,CUTTACK
  - 3) Tender documents should be down loaded from **Banks Website.**
  - 4) Time of completion : 15 Days
  - 5) Earnest money : Rs.7000.00
  - 6) Defect liability period : 1 year after completion of work  
(Issue of completion certificate)
  - 7) Initial Security Deposit : 2% of executed value of work.
  - 8) Retention Money : 10% of gross value of each Bill.
  - 9) Liquidate damage : 1.0 % of the tender value per week  
Subjected to maximum 10 % of the  
Tender value
- 10) Eligibility/Pre-qualification of Contractors: Experience of having successfully completed similar works during last 7 years ending last day of the month previous to the one which applications are invited should be either of the
- a. 3 similar completed works costing not less than the amount equal to 40% of the estimated cost. OR,
  - b. 2 similar completed works costing not less than the amount equal to 50% of the estimated cost
  - c. 1 similar completed works costing not less than the amount equal to 80% of the estimated cost
- 11) Tenderers might be called upon before the final awarding of contract for any clarifications regarding the quoting of the tenders
- 12) The Earnest money shall be refunded to the unsuccessful tenderers within fifteen days without any interest.
- 13) The employer will not be bound to accept the lowest tender and reserves the right to reject any or all tenders without assigning any reason thereof.
- 14) Tenderer must have our Bank empanelment letter with class higher than work value estimated from Patna Zone only and company must be from Odisha only.**

For & behalf of  
BANK OF BARODA  
REGIONAL OFFICE, CUTTACK.

**DOCUMENTS FURNISHED BY THE TENDERER.**

**Tender should be submitted in single bid system only.**

**Note: Composite tender will not be entertained.**

**ENVELOPE CONTENT.**

Envelope shall contain the following documents.

- 1) Forwarding letter with mentioning the cost of Tender value arrived at with quoted rates & tender paper technical volume.
- 2) Earnest money deposit furnished in the form of Crossed Demand Draft/ Banker's Cheque drawn in favor of BANK OF BARODA and payable at CUTTACK for the amount indicated in the Notice of Invitation to Tender.
- 3) Bank's empanelment letter from Patna Zone only
- 4) Any comment which the tenderer desires to make in the form of a statement as brief as possible and with reference to the items.
- 5) Envelope shall contain the priced tender Volume of the tender paper.
- 6) The envelope should be endorsed on the outside face **"TENDER FOR INTERIOR FURNISHING WORK OF BANK OF BARODA BANKI BRANCH.**
- 7) The tender will be rejected if all the documents above said are absent.

बैंक ऑफ बरोडा  
Bank of Baroda

### GENERAL INSTRUCTIONS TO TENDERERS

- 1) The term “**Employers**” or “**Bank**” shall mean “Bank of Baroda”, or its authorized representatives at The Regional Office, Cuttack.
- 2) The term “**Architect(s)**” shall mean “**M/s Curves Architecture**. Who are the Architect Consultant to the Employer for this project & having office at Plot, 33, Bankers Enclave, Palasuni, Bhubaneswar. or its authorized representatives.
- 3) The term “**Contractor**” shall mean the **successful tenderer** to whom the Contract shall be awarded.
- 4) The “Works” shall mean the Interior works comprising of Furnishing work for **BANKI Branch**.
- 5) The Contractor should quote the rates in figures and words. Any corrections or Over-writing should be initialed/signed by the Contractor.
- 6) The Contractor should submit the tenders with seal and signature on each Page.
- 7) Tender should be submitted in sealed covers with all requisite documents as desired with the top of the envelope superscripted as “**SEALED TENDER for Total Interior Furnishing works For BANKI Branch**.”
- 8) The Contractors should submit the cost of the main items as per tender specifications. Further modification after awarding of the contract shall be not allowed unless there is specific instruction by the Bank/Architect to change specifications.
- 9) The contract is time-bound and the works are to be completed within the time limit specified in the notice inviting tenders.
- 10) **Additional Performance Security shall be deposited by the successful bidder when the bid amount is seriously unbalanced i.e. less than the estimated cost by more than 15%. In such an event, the successful bidder will deposit the additional performance security to the extent of the differential cost of the bid amount & 85% of the estimated cost. (Additional Performance Security = 85% of the Estimated Cost – Bid Amount)**
- 11) Additional Performance Security shall be deposited by the successful bidder when the bid amount is front loaded i.e. if the quoted value is 15% higher than the estimated rates, the bid shall be evaluated as unbalanced bid and additional performance security of 10% shall be retained on the amount of quoted value.
- 12) The additional performance security as per clause 10 & 11 shall be furnished by the bidder before execution of the work in shape of Demand Draft or Fixed Deposit Receipt at any Nationalized bank pledged in favour of **Bank of Baroda, Cuttack** which will be over and above the performance security.
- 13) The Contractor shall be penalized if the work is not completed within the scheduled time, the Bank will be entitled to charge liquidated damages @ 1% of the accepted contract sum per week subject to a maximum of 10% of the accepted contract sum.
- 14) The decision of Employer and the Architect is final and binding.

## TERMS & CONDITION

- 1) Unless otherwise mentioned, all works are with no allowance for Lapse waste. Unless otherwise described or measured separately, price for all the items shall include all necessary straight & curved edges.
- 2) Any damage to the work before the site is handed over, is to be replaced or made good at the expense of the contractor to the entire satisfaction of the Architect/Bank.
- 3) Income Tax as applicable shall be deducted at source as per the Income Tax Act/Rules.
- 4) The quantities indicated are subject to change. The payment of the bill shall be made as per the actual measurement as certified by the architect but not exceeding the total value quoted in the tender form.
- 5) The Architect or any officer of the Employers will be free to inspect the work at the site during the period of execution. Any suggestion of change or modification to improve the quality of work will be carried out subject to prior approval of the competent authority of the employers and that of the Architect.
- 6) In case of failure to take up the work even after accepting the work order, or leaving the work incomplete, or for defective work not rectified, or violation of the terms and conditions, the earnest money deposit will be forfeited.
- 7) For any item of work not covered or any unforeseen items of work, payment will be made according to the rates approved for similar nature of work, the costing done by the Architect, as per current PWD schedule of rates, or as per analysis of material cost, labour rate and profit to the Contractor at 10%. The Contractor must obtain prior approval in writing before undertaking such additional works.
- 8) The tenderers shall sign each & every page of the tender documents including the drawings attached here to.
- 9) The amount is to be quoted in figures as well as in words. In case the rates quoted in words and in figures are in variance, the amount written in words shall be taken as final.
- 10) The Contractor shall make their own arrangement at their own cost for storing materials, plants, tools etc. The employers will not be liable for security of the Contractor's materials.
- 11) No tools or plants will be issued by the bank.
- 12) The Employer / Architect reserves the right to accept or reject any tender without assigning any reason whatsoever and the said decision shall be final and binding upon the tenderer.
- 13) In case of breach of contract by the Contractor for slow progress of works or any other claim of damage, the Employer or the Architect may have the power to rescind the contract without furnishing further reasons thereof.
- 14) The Architect / Employer shall have the power to ask the contractor to furnish the sample/ color / test certificate from any Govt. /Authorized agent for any materials used/ to be used in the Works, the expenditure of which is to be borne by the Contractor.
- 15) The Employer shall be not be liable for any damages or compensation payable as a consequence of any accident or injury to any workman or other persons in the employment of the Contractor or any sub-contractor.
- 16) On completion of the Works, all rubbish, debris, materials, tools, Laborers, etc. to be removed by the contractor from the site and the contractor will hand over the site clean & clear & in usable condition within 3 days of completion of the works. Failing this, the employer may dispose the materials at the cost of the contractor.

17) In case of any dispute, the matter will be referred to the **Regional Manager, Bank of Baroda, Regional Office, Cuttack.**

18) The Contractor shall not submit any work bill until he completes the Project completely, as certified by the Architect Consultant.

19) The rates quoted in the tender shall exclude GST but include other taxes, no escalation of rates will be allowed under any circumstances



### **SPECIAL TERMS AND CONDITIONS**

1. Completion Period : 15 Days
2. Date of Commencement : 7 days from the date of issue of the work order or the date on which the contractor is instructed to take possession of the site, or the date of your acceptance of the work- order, whichever is later.
3. Defect Liability Period : One year after actual completion of work.
4. Initial security deposit (ISD) : 2 % of accepted value (Including EMD).
5. Limit of variation : 100% without any change in price if work is done within six months of the contract and with prior consent of Architect / Consultant.
6. Additional items : For items where unit rates are not available, contractor shall provide proper cost break-up and proceed only after approval/consent. Any sample to be made for approval shall be at the Contractor's cost.
7. Validity of tender : Three month after the opening of the tender.
8. Rules/ Regulations : The contractor shall have there responsibility of complying with the local shops/establishments Act and other labor/ minimum wages Act and shall keep all such records/ accounts on payment of wages / attendance as deemed necessary.
9. Arbitration :As per the standard arbitration clause under the jurisdiction of Odisha.
10. Organization : The contractor shall employ competent / qualified supervisor /Engineer-in-charge who shall be responsible for the day to day work and coordinate as necessary with the Architect's supervisor. Any workman found guilty of misconduct/theft shall remove from the site.
11. Damage to property : Any damage to the Bank's property during the work period will be recovered from the contractor.
12. Deduction : Income tax, at source as per Act.
13. Terms of payment : 100% Payment after completion of Project.
14. Billing Procedure : All measurements shall be recorded in Duplicate on standard measurement sheets Prepared jointly by the Architect's Site Engineer & The Contractor's Representatives duly signed by them. All Bills shall be submitted along with this Checked measurement sheets.
15. Time schedule of work : The Contractor must submit before the Commencement of work, a Bar chart showing the date of commencement & the date of completion of

each item of Work as mentioned in the Schedule of Quantities.

16) Release of TSD

: 100% after the Defect liability period. Retention money will not bear any interest.

17. General

The rates should be quoted considering necessary Scaffolding & staging work, Removal of debris as & when necessary, In view of restriction of Local concern Authority.





## LIST OF MATERIALS (INTERIOR WORK)

1. Synthetic Plastic Emulsion : Berger, Asian, J & N
2. False ceiling : Gypsum India, Armstrong
3. Floor tiles : KAJARIA, NITCO, SOMANY
4. Laminates : MERINO, GREENLAM .
5. Smoked Mirror/Glass : Modiguard , Saint Govind , Asahi Indian
6. Floor Spring : Godrej , Harwin
7. Locks : Godrej, Doorset , Apex
8. Hardware : Harrisson, Earl Bihari. Ebco
9. Nails, Screws etc. : Nettle fold or equivalent
10. Adhesive : Fevicol SH, Jeevanjod
11. Aluminium section : OEL, JINDAL
12. Vertical Blinds : Vista Leover, MAC
13. Ply : GREEN PLY, SABURI ( ISI 303 Grade )
14. Block Board : GREEN PLY ,SABURI ( ISI 1659 Grade )

बैंक ऑफ बरोडा  
Bank of Baroda

**BOQ FOR INTERIOR DECORATION AND FURNISHING OF BRANCH PREMISES OF  
BANK OF BARODA ,BANKI BRANCH**

Sl. No.	Particulars	Unit	Quantity	Rate ( in Rs.)	Amount ( in Rs.)
<b>1</b>	<b>SWO/Bank Counter:</b>				
	Providing and fixing of counter table of size 5'0"x3'-0"x 2'-6" with Modular Table Top of 25 mm thk Ply Board and the front fascia is raised up to ht of 3'-10" and front drawer unit consisting 3 Nos of drawer units slides on telescopic slider made up of 19 mm thick BWP grade ply ( <b>CENTURY/SABURI</b> ) ply with locking arrangement. The exposed edge surfaces are to be finished with 1.0 mm th. laminates as per design of approved shade and the inner surface to be finished with 0.8 mm thick laminate of approved shade . A cable manager is to be fixed as per drawing and design. It also include a 12 mm thick fully edged and edge polished 15" wide horizontal glass member fixed with the partition by SS patch panel and SS stude as per design. The work is to be completed with all labour and material as per drawing and design including all the hardware required.				
	<b>Ø High Level Cash Counters</b>	Rft	5.00		
	<b>Ø Low Level Cash Counters/Front office counter/Clerk table</b>	Rft	12.00		
<b>2</b>	<b>Full Height Partition (Glazed/Semi Glazed/Solid)</b>				
	Providing and fixing in position partly glazed full Height Partition work as per drawing in frame work at 600 mm X 600 mm grid (horizontally and vertically) comprising of 50 mm X 50 mm Aluminium section of heavy gage as per frame work shown in the drawings with 12 mm BWP Grade Solid Ply ( <b>CENTURY/SABURI</b> ) on both sides finished with 1.0 mm thick laminates of ( <b>GREENLAM/MERINO</b> ) approved shade and colour as shown in drawings. Item to include 12 mm thick Toughened glass with approved colour etching and frosting as per design and 2"x2" T.W. member for door sides and glass sides and T.W. door frame to take 12 mm thick glass with etching and frosting. All exposed T.W. surfaces to be finished in melamine polish of matching laminate colour as directed	SFT	520.00		

	including all necessary Stainless Steel finish fittings/hardware, wood preservative paint etc. as per list of approved material and as approved by the Project Consultant/Bank complete in all respects				
<b>3</b>	<b>Low height partition (up to 1500 mm ht.)</b>				
	Providing and fixing in position partly glazed full Height Partition work as per drawing in frame work at 600 mmX600 mm grid (horizontally and vertically) comprising of 50 mm X50 mm Aluminium section of heavy gage as per frame work shown in the drawings with 12 mm BWP Grade Solid Ply ( <b>CENTURY/SABURI</b> ) on both sides finished with 1.0 mm thick laminates of ( <b>GREENLAM/MERINO</b> ) approved shade and colour as shown in drawings. Item to include 12 mm thick Toughened glass with approved colour etching and frosting as per design and 2"x2" T.W. member for door sides and glass sides and T.W. door frame to take 12 mm thick glass with etching and frosting. All exposed T.W. surfaces to be finished in melamine polish of matching laminate colour as directed including all necessary Stainless Steel finish fittings/hardware, wood preservative paint etc. as per list of approved material and as approved by the Project Consultant/Bank complete in all respects	SFT	110.00		
<b>4</b>	<b>Doors (Glazed/Semi Glazed/Solid)</b>				
	Providing and fixing Glazed/semi glazed/Solid doors of sizes as shown in the drawing.The door shutter shall of 32 mm thick Solid Core BWP Grade flush Door shutter of ( <b>CENTURY/SABURI</b> ) make and finished with 1.0 mm thick Laminate on both sides as per architects direction..The shutter will have partly glazed 12 mm thick Frosted toughened glass, side beveled ,with vision panel, high polished with body etching/Colour LOGO .The rates are inclusive of approved patch fitting locking system,1 pair of 24" long S.S Handles of approved make,heavy duty Floor spring,Door closure,Mortise lock,top pivot,top patch fittings,bottom patch fittings,corner lock with strike plate and euro profile cilinder and all labour, materials, taxes, leads & lift to the place of work executed to the satisfaction of the Architect./BOB.	SFT	90.00		

b.	<b>FRP Door:</b> Providing and Fixing Fire Resistance Proof Door(FRP) minimum 2 hours Fire Rating at UPS,Store & Safe Room.Door Frame are made with 1.6mm thick galvanized steel sheet pressed to single rebate profile of size 125 x 60mm. Door Shutter are made with 1.25mm thick galvanized steel sheet pressed formed to provide a 46mm thick fully flush double skin panel shall with lock seam joint at style edges. The cost includes all the materials,necessary fittings,locking arrangement, labour, transportation taxes etc., complete for the work.	SFT	60.00		
5	<b>Wall &amp; Column Panelling (With Laminate Finish)</b>				
	Encasing to columns , Banking hall etc where ever shown in drawings by fixing 12 mm thick BWP Grade Ply ( <b>CENTURY/SABURI</b> ) and providing 6.0 mm thk horizontal grooves to the frames made out of Heavy duty Aluminium Box sections 50mmX25mm@600mm c/c,both ways horizontally and vertically on the wall by means of nailing or screwing over with 1 mm thick laminate of approved shade fixed by means of adhesive having grooves & necessary white beach beading as directed by the Architect finished with wooden moulding,skirting & Lipping etc. . At places niches shall be created to accommodate 12 mm tk soft board & fabric of approved quality fixed with necessary frame work of wood . Nitches shall be leaped with WB wood which is also melamine polished. The cost includes all the materials, labour, transportation taxes etc., complete for the work.	SFT	270.00		
6	<b>Flap Door (up to 1.5 M. ht)</b>				
	<b>Flap Door:</b> Providing, fitting and fixing of flap door with frame work made out of 35mmx35mm thick hard wood and nailed with 6mm. thick ply and finished with 1mm. Thick laminates of approved colour and design on both the surfaces of the frame work as per drawing and design.The edges of the door to be covered with decorative wood moulding with two coat of superior wax polish.The work is to be finished with all material ,labour,nails,screws,hings,locks,handles,door closer and all other hard wares as per detail drawings.	SFT	13.50		
7	<b>Main Entrance Door (With Toughened Glass)</b>				

	Providing and fixing fully glazed Aluminium (heavy duty 14 gauge) Doors at the Main Entrance with 6"x2" sections for top & bottom rails, 2"x2" for vertical styles. 12mm thk toughened glass with frosting and etching/LOGO shall be fixed in the framing. Rate shall include pad lock, heavy duty floor spring (2 nos), 18" long S.S Handles (2 nos), gaskets, top and bottom patch fitting locking systems of approved make.	SFT	72.25		
<b>8</b>	<b>Night latches</b>				
4	Providing and fixing Godrej <b>Night latches</b> to cash cabins and finished smooth.	no	1.00		
<b>9</b>	<b>Door Closer</b>				
	Providing and fixing Godrej make over head door closers to manager's chamber door with necessary fixtures and fittings etc.	NOS	6.00		
<b>10</b>	<b>False ceiling (With Tray &amp; Drop)</b>				
	False Ceiling (Gypsum Board) Providing & fixing in position false ceiling in Gypboard 12 mm thick (with 3" cornice) for horizontals & Verticals fixed over G.I. frame work as specified by India Gupsm Co. Ltd. including trap doors for A.C. Unit in 18mm thick M. R. Grade Plywood with Stainless Steel hinges & locks with moulding 1" x 1" for edges including finishing with White Plastic Emulsion Paint etc. complete in all respects. (Note :- Only the plan area will be measured for payment. No extra payment will be made for cutouts, grooves, mouldings etc.)	SFT	607.50		
<b>11</b>	<b>Mineral Fiber Board/Grid Ceiling:</b>				
	Providing & fixing in position false ceiling in Armstrong 600 x 600 mm x 15/16 mm Dune Supreme RH 95 Prima tile with sheihard gride Tegulare edge framework as specified by Armstrong Co. with suspenders wherever required. Making necessary framework for A. C. ducting, if any, and necessary cutouts for diffusers and light fittings, taping and finishing to proper line & level, including making grooves and trap doors for A. C. unit in 18 mm thick M. R. Grade Plywood with Stainless Steel hinges & locks with moulding 1" x 1" for edges including finishing with White Plastic Emulsion Paint etc. complete in all respects. (Note :- Only the plan area will be measured for payment. No extra payment will be made for cutouts, grooves, mouldings etc.)	SFT	272.00		
<b>12</b>	<b>Calcium Cera Board</b>				

	Supplying all materials, labour T&P for Providing and fixing 8mm thick shera board on Ceiling with grooves as per design including cost of all materials, adhesive required for the work including all labour T&P required for complete the work as directed by EIC.	sft	40.00		
<b>13</b>	<b>Manager's Table</b>				
	Providing modular executive type manager table top of size 5'-6"X3'-0"X2'-6",with Modular Table Top of 25 mm thk Ply with Postforming edges and a side credenza of size 3'-0"X1'-6"X2'-6" and a front drawer unit consisting 3Nos of drawer units slides oon telescopic slider made up of 19 mm thk BWP grade ply <b>(CENTURY/SABURI)</b> with locking arrangement. The exposed edge surfaces are to be finished with 1.0 mm thick laminates as per design of approved shade and the inner surface is finished with 0.8 mm thk laminate of approved shade . A cable manager is to be fixed as per drawing and design.The side credenza will have two drawer unit slides on telescopic slider and two cupboard unit. The work should be completed including all labour and material.	NOS	1.00		
<b>14</b>	<b>Workstation Table</b>				
	Providing and fixing of Back office counter table size of 4'-6"X2'-6"x2'-6" with Modular Table Top of 25 mm thk Ply with Postforming edges and consist drawer units slides on telescopic slider and a cupboard unit made-up of 19 mm thick BWP Grade Ply <b>(CENTURY/SABURI)</b> with locking arrangement. The unit also include a 4" front edge band . The exposed edge surfaces are to be finished with 1.0 mm thick laminates as per design of approved shade and the inner surface is finished with 0.8 mm thick laminate of approved shade . A cable manager is to be fixed as per drawing and design. The work is to be completed with all labour and material including all the hardware required.	NOS	1.00		
<b>15</b>	<b>Low Height &amp; Full Height Storage ( 450mm Depth )</b>				

	Providing and fixing of low height storage cabinet & backside storage at manager chamber having 450 mm. depth & 25 mm thk Modular Top made from 25 mm thick BWP grade Solid ply ( <b>CENTURY/SABURI</b> ) all side finished with 1.0 mm thick Laminate of approved shade on the exterior side as per design of approved colour and the inner surface is finished with 0.8 mm thick Laminate of approved colour. The work shall be completed with all necessary hardwares i.e, S.S Handles,brass locks,wall catches etc,labour and materials etc.	SFT	80.00		
<b>16</b>	<b>Key Board Tray</b>				
	Providing & supplying metal keyboard tray without Mousepad manufacture by M/S Godrej/EBCO.The Keyboard is pullout type, fixed to channels and screwed to below table top.	NOS	7.00		
<b>17</b>	<b>CPU Trolley</b>				
	Providing & supplying metal CPU trolley manufactured by M/S Godrej/EBCO attached with 4 wheels for holding CPU and smooth movement.	NOS	7.00		
<b>18</b>	<b>Suggestion Box</b>				
	Supplying and erecting free-standing suggestions box of overall size , 450 mm long x 300 mm deep x 900 mm high made of 19 mm thick phenol formaldehyde block board, all as in drawing, complete. with hardware. Fittings and fixtures of approved make and quality. Top and all exposed surfaces of block board are to be finished with 1mm thick laminate sheet of approved shade and quality. Inner faces of block board surfaces are to be finished with minimum two coats of synthetic enamel paint of approved shades and quality over a coat of approved primer.	NOS	1.00		
<b>19</b>	<b>Cheque Drop Box</b>				
	Supplying and erecting cheque drop box (overall size 450 mm x 300 mm x 750 mm) made. of 19mm thick phenol formaldehyde bonded plyboard and the curved portion at top made out of 90 mm x 90 mm C.Pteak woodsection. A slit opening of 10 mm x 150 mm is to be provided at the top of the box. An openable shutter of 259 mm x 262 mm size made of 19 mm thick phenol formaldehyde bonded block board is to be provided at 1.50 m above finished floor level. All the exposed timber surfaces including. all free edges are to be finished with 1 mm thick laminate sheet of	NOS	1.00		

	combinations shade .Inner faces of block board surfaces are to be finished with minimum two coats of synthetic enamel paint of approved shade and quality over a coat of approved primer. Rate to include cost of necessary hardware fittings e.g. brass hinges, lock, knob etc. of approved design and quality.				
<b>20</b>	<b>Writing Platform for Customers &amp; Application Form Set</b>				
	Providing , fitting , fixing writing platform at a height of 4' above floor level fixed to the wall made out of 19 mm BWP block board with lamination 1 mm tk on top & hard wood beading ducco painted . At least 10 nos vertical slip in chalan shelves attached to wall over writing platform made out of min 4 mm tk acrylic sheets with 6 mm tk ply back up. Each chalan shelf will be of size 6" height , 6" wide .The entire unit will be complete in all respect including materials , labor etc to the satisfaction of consultant .	NOS	1.00		
<b>21</b>	<b>Notice Board.</b>				
	Providing soft board covered with approved fabric with wooden frame work and decorative beading for display drawings and documents, with locking arrangement of the sliding shutter made up of 8mm th. float glass. The work should be done including all labour and material.	NOS	1.00		
<b>22</b>	<b>Vertical Blinds</b>				
	Supplying, fitting & fixing in position coloured 0.33mm thickness acrylic coated cleanable/ washable Roller blinds (Marvel or its equivalent, as approved) inclusive of all recommended accessories colour pattern etc., as per Architect's approval. The cost includes all the materials, labour, transportation taxes etc., complete for the work.	SFT	80.00		
<b>23</b>	<b>Wall Plastic Paint.</b>				
	Providing & applying 2 coats of plastic emulsion paint of royale ICI dulux & approved shade on wall, columns, beams, ceiling, etc. of back office hall including locker room, including preparation of surface, sand papering the intermediate coats, including cost of all materials, labour, conveyance, taxes, royalties, scaffolding, watering, curing, sundries, T&P, etc., as per direction of Engineer-in-charge.	SFT	2,850.00		
<b>24</b>	<b>Wall Putty Work (With P.O.P Punning)</b>				



	Providing and applying wall puttywork in order to make the total plastered wall surface perfectly leveled, including cost of all materials, labour, conveyance, taxes, royalties, scaffolding, watering, curing, sundries, T&P, etc., as per direction of Engineer-in-charge.	SFT	1,400.00		
<b>25</b>	<b>Rolling Shutter Boxing (With A.C.P)</b>				
	Providing & fixing 3 mm thick Aluminium Composite Panel boxing for existing rolling shutter. Necessary arrangement shall be provided for trap door for smooth operation of shutters and rest is closed with mirror screws. The shutter shall be finished with approved 3.0 mm thick ACP on all exposed sides, enamel paint internally and the rates shall be inclusive of all fittings like hinges, ball catches, tower bolt (Ebc make) etc	SFT	110.00		
<b>26</b>	<b>Banks Logo, Poster Frame, Pin Board</b>				
	S.S logo for table & Back drop logo for manager chamber of Bank Of Baroda in SS plate of 18 inch & 24 inch and Poster Frame - one set poster frame consisting 2 sheets of impreg. acrylic of 5 mm thickness front sheet with half inch moulding and edge polished; back sheet with polished edge and Aluminium stud for fixing the frame on wall, One Pin Board for fixing Notices and other communication made of 24"X18" soft board, with hardwood and aluminium frame, covered with satin of appropriate colour.	NOS	7.00		
<b>27</b>	<b>Electrical Panel Board Cover:</b>				
	Providing and fixing of electrical panel board cover made up of 19mm ply with two shutter at the front having T.W luvvers as per drawing and design, it also have furnished with locking arrangement. The exposed surface is finished with 1mm. Th. Laminates and inner surface is finished with two coats of plastic emulsion paint over one coat of primer. The work should be completed including all hardware, material and labour.	Sft	28.00		
	<b>TOTAL</b>				

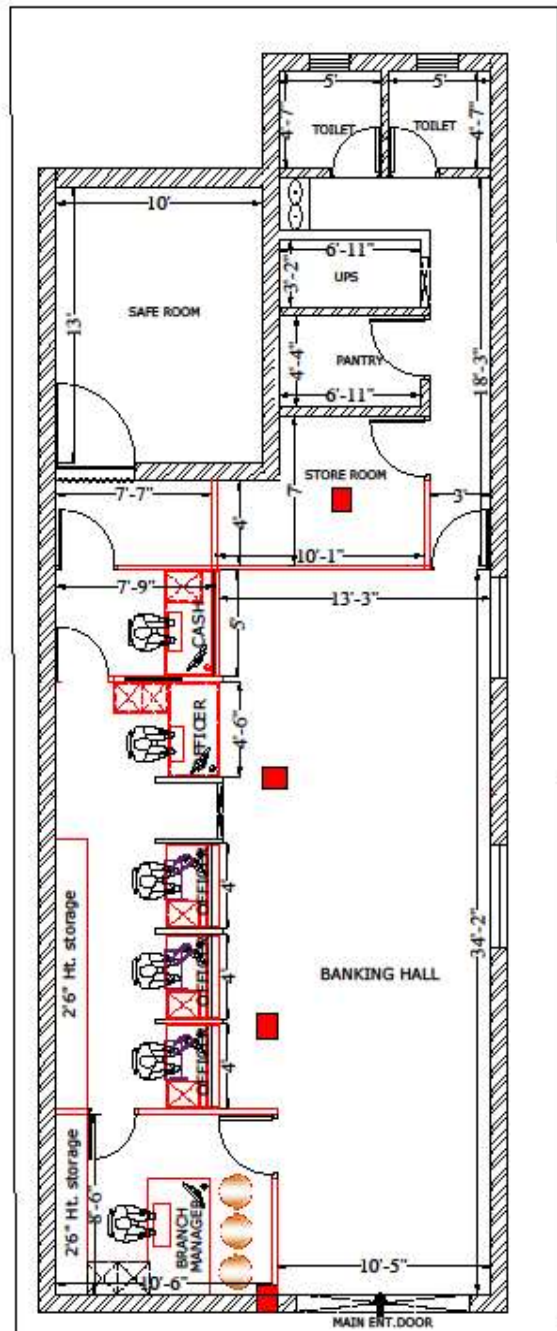

Carpet Area of Branch - 1109.28 sq.ft. (Excluding Toilet)

TITLE ARCHITECTURAL LAYOUT PLAN OF BRANCH OF FEDERAL BANK BRANCH		DRAWING NO. DATE SCALE	PROJECT NO. 1109.28
			DRAWING DATE - 10-10-2011

DESIGNER ARCHITECTURE	PROJECT NO. 1109.28 DRAWING DATE - 10-10-2011
--------------------------	--

